



# FOSHAN

## WHERE SWISS SERVICE AND SKYLINE CITY VIEWS SOAR TO NEW HEIGHTS

### Swissôtel Foshan, Guangdong

1 Chengmentou West Road, Chancheng District, Foshan City, Guangdong Province, 528000, P.R. China

Tel +86 757 8236 2888 Fax +86 757 8236 2999

reservations.foshan@swissotel.com www.swissotel.com/foshan

**swissôtel FOSHAN**  
GUANGDONG

### LOCATION

#### PANORAMIC VIEWS OF A VIBRANT CITY

Life's good at the top. And the view from the 51st floor of Swissôtel Foshan confirms this. Soaring 208 metres into the sky, you can enjoy dramatic views of the city while relaxing in one of our signature restaurants, the outdoor pool or Executive Club Lounge. Located close to Zumiao Commercial District and Lingnan Tiandi entertainment area, you are just minutes from Guangfo Metro and Foshan Highway, an expressway linking Foshan to Guangzhou and Shunde. This is an ideal spot for both business and sightseeing. Our contemporary Swiss style is one thing. The warm welcome that awaits you, as well as the services and amenities on offer will make for a memorable stay.



### GUEST ROOMS

#### A WELCOME SIGHT AFTER A LONG DAY

The cityscape view from the comfort of your own room is a welcome sight after a long day. As soon as you step inside one of our 232 guest rooms and suites you will feel the stresses of the day melt away. You'll like how the contemporary Swiss style blends seamlessly with Chinese influences, colours, textiles and artwork. We have everything you need for a good night's sleep; quiet rooms, crisp white Swissôtel signature bedding with a luxury thread count and our very own à la carte pillow menu. Relax at a higher level in one of our Swiss Business Executive Club rooms and suites, which are located on the uppermost floors. These rooms provide access to the Swiss Executive Club Lounge with a meeting room for business travellers and private workstations.

### RESTAURANTS & BARS

#### INTERNATIONAL CUISINE FOR ALL OCCASSIONS

Swissotel Foshan serves an enticing selection of food and wine in each of its five signature restaurants and bars. Our contemporary Italian restaurant offers magnificent views from the 51st floor as well as five semi-private dining rooms if you are looking to hold an exclusive function. With 23 VIP rooms a main dining hall and grand décor throughout, The Imperial Delux can provide a unique, high-end dining experience for business or leisure functions of all sizes. If you are after a more relaxed and informal setting then head to Café Swiss and sample the extensive international buffet and à la carte menu, or enjoy light snacks in The Flow Lounge and Bar. Bar 51 is the place to go to for the best cityscape views and signature cocktails in a sophisticated setting from the hotel's 51st floor.





## SPA & GYM

### WORKOUT & UNWIND TO PANORAMIC VIEWS OF FOSHAN

Immerse yourself in Alpine freshness. Our Touch Spa & Gym offers an idyllic setting to relax and unwind. State-of-the-art exercise equipment and jogging routes will help you clear your mind after a busy day before you submerge yourself in our luxurious outdoor pool. Our signature treatments will also rejuvenate your mind, body and soul.

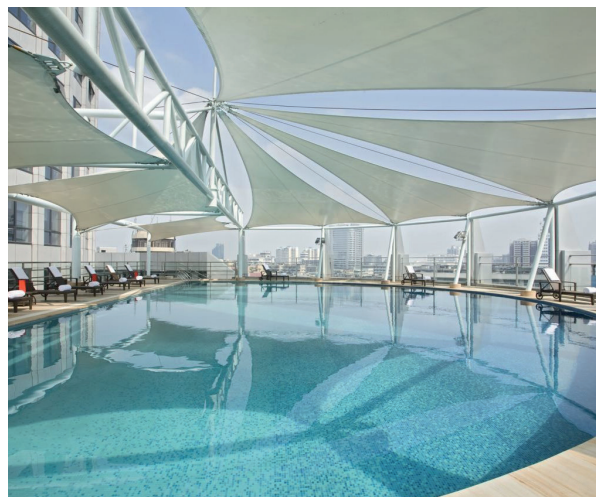

## MEETINGS, EVENTS AND CONFERENCES

### INSPIRING BUSINESS

Named after famous mountains in Switzerland our seven exclusive meeting and function rooms are decorated to the highest standard with the latest technology. Monte Rosa Grand Ballroom is our largest and most exclusive events area offering 1,050 square metres of innovative space catering for up to 500 guests in a banquet set-up. With natural daylight and impressive 180-degree views of the city, the Matterhorn Ballrooms is ideal for energising business meetings or social functions. A dedicated events specialist will help you will all aspects of your event planning to ensure your event is a success.

## BUSINESS CENTRE

### FOR ALL YOUR BUSINESS NEEDS

Everything you need to conduct your business remotely and effectively such as a conference room for up to six people boardroom style. Services include high-speed internet, photocopying, typing, faxing, binding, translation and printing.



## FACILITIES & SERVICES

### SWISSÔTEL FOSHAN HIGHLIGHTS

- Centrally-located 5-star hotel
- 25-minute drive from Foshan Airport
- Located close to Zumiao Commercial District and Fenjiang Financial District
- 232 beautiful and contemporary guest rooms and suites
- Executive Lounge (for Executive Club floor rooms and above)
- Professional conference, meeting and event facilities
- Business Centre
- Wireless internet
- Five signature restaurants
- Spa & fitness centre
- Outdoor pool
- 24-hour in room dining
- Bank/foreign exchange
- Postal and parcel services
- Same-day laundry and valet services
- Satellite TV (selected channels)
- Basement car park with 250 lots
- All major credit cards accepted



CAPACITY CHART

MEETING ROOMS	AREA M <sup>2</sup>	MAX NO. PERSONS	L	W	H	BOARD ROOM	U SHAPE	CLASS ROOM	THEATRE	ROUND TABLES
Monte Rosa Ballroom	1050	800	34	32	5	80	100	400	800	500
Matterhorn Ballroom	211	180	22	14	3	36	60	100	180	120
V1V2 (5F)	211	160	22	7	3	36	60	100	160	100
Jungfrau	72.5	55	10	5.8	3	24	21	36	55	30
Moench	64	50	9.6	7	3	24	21	30	50	30
Eiger	63	20	11.3	5.8	3	20	18	/	/	/
Rigi	34	25	7	5.5	3	12	12	20	25	20

LEGEND

Meeting Room or Ballroom

Restrooms

Escalator

Elevator

Food & Beverage Outlet

Emergency Exit

Stairway

Window

Moveable Partition

