



swissôtel CHICAGO

A PASSION FOR PERFECTION

LOCATION

Swissôtel Chicago is located where Lake Michigan meets the Chicago River. We're just a short walking distance from the "Loop," financial district, government center, cultural institutions and museums. Here, you are at the center of diverse activities and major shopping districts such as The Magnificent Mile and State Street.

ACCOMMODATIONS

Guest Rooms

Beginning April 2008, each of our newly renovated rooms will feature a specialty Swiss Comfort Bed, a 37" high-definition split-screen plasma television and a frameless glass shower stall. To further accommodate the hotel's large number of business travelers, the rooms will include the following upgrades and amenities:

- Oversized executive desks with spacious workspaces
- Mini-bars
- State-of-the-art, contemporary ergonomic chairs
- Technology docking centers to use a variety of media devices simultaneously
- DS3 Internet technology—equivalent to 28 T1 lines
- Virtual local area network capabilities for meetings

Suites & Presidential Suite

Swissôtel Chicago offers 35 suites in an array of styles with features that will exceed your expectations. As of April 2008, highlights will include DVD players, 42"-50" high-definition split-screen plasma TVs, access to Swiss Executive Club Lounge, separate living areas and oversized workspaces.

SWISS EXECUTIVE CLUB LOUNGE

Take advantage of the Lounge's personal concierge service, express check-in and check-out privileges, keyed access and study and meeting room area with complimentary Internet usage. Additional features include a library, flat-panel TV, international newspapers and magazines, plus morning continental breakfast and evening hors d'oeuvres.

42ND FLOOR HEALTH CLUB & POOL

Overlooking panoramic views of Lake Michigan, the Penthouse Health Club and Pool helps you stay in tiptop shape while you are away from your home gym. Pump up your energy level with a circuit on our comprehensive array of aerobic machines, strength equipment, free weights, Lifecycles, recombiant bicycles, treadmills and Life Fitness equipment. Then cool off with a dip in our sparkling 45-foot indoor pool, or ease your tired, tense muscles in the dry sauna or Jacuzzi. Massage services are also available.

RESTAURANTS & LOUNGE

Geneva Restaurant

Indulge in a full American breakfast with European flair. In the afternoon and evening hours, the restaurant transforms into banquet or meeting space for up to 140 people.

Lobby Lounge

Stop into the center of action at our Lobby Lounge. View the sunrise over a spread of European pastries, and energize your day with freshly brewed coffee. Later, watch the bustle of our urban hotel from a plush seat near the fireplace as you sip a glass of Chardonnay.

The Palm

During your visit, experience a dining tradition that's been going strong for three generations at this acclaimed restaurant. For lunch or dinner, choose from a savory selection of tender aged prime beef, traditional Italian fare and outrageously sized lobsters.

OTHER SERVICES & AMENITIES

- Automated Teller (ATM)
- Baggage Storage
- Concierge Desk
- Gift Shop
- Laundry/Valet Service
- Multi-Lingual Staff
- 24-Hour Room Service
- Babysitting Service
- 24-Hour Valet Parking

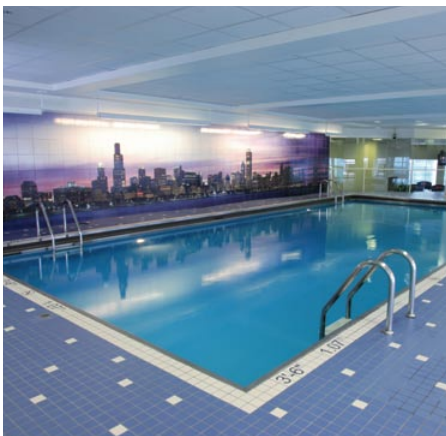

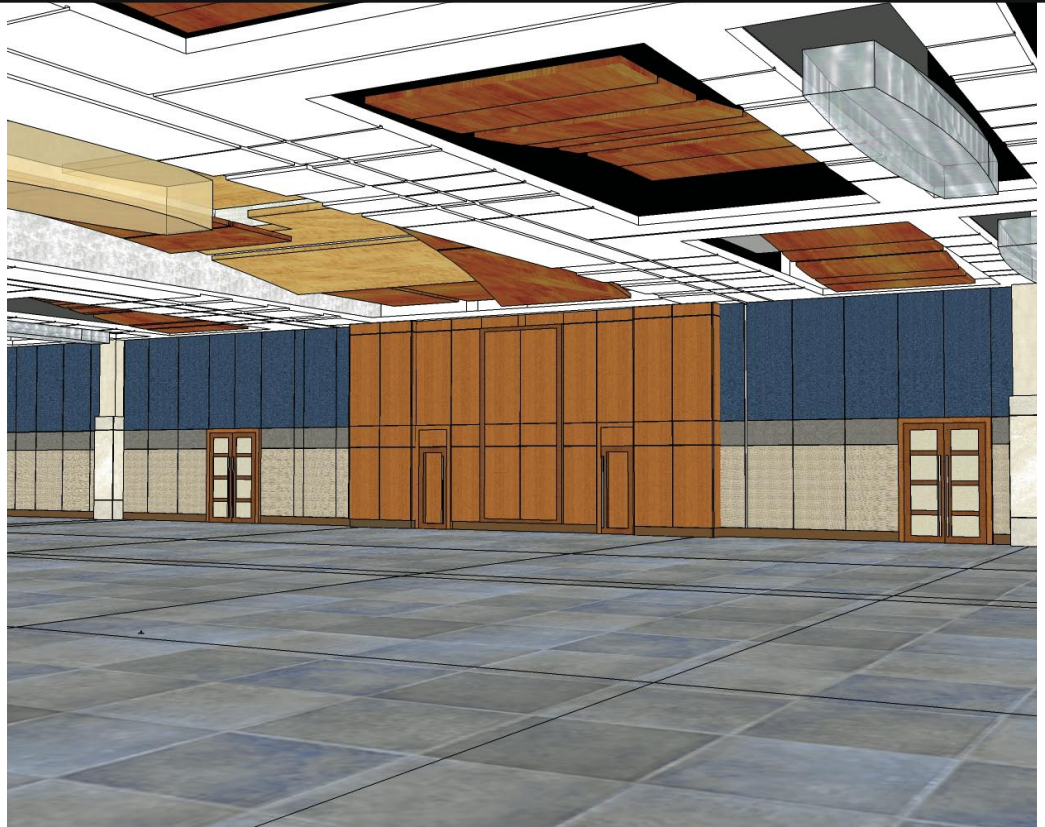

CONFERENCES & MEETINGS

With 27,000 square feet of flexible meeting and function space, Swissôtel Chicago is amply prepared for your business agenda. Choose from two handsomely furnished executive boardrooms, a 60-seat tiered theater and 18 private suites that can accommodate 12-30 participants. All conference rooms feature audio/video conferencing and iBAHN NextConnectSM high-speed wired and wireless Internet access. The 6,106-square-foot Grand Ballroom and the 2,400-square-foot Alpine Ballroom are considered two of the city's most technically sophisticated ballroom venues.

Expansion Plan

In June 2009, Swissôtel Chicago will unveil their expansion comprised of 30,000 square feet of meeting space, including a state-of-the-art 15,000-square-foot ballroom. The combination of new and current space will position Swissôtel Chicago as an ideal meeting venue, whether for an executive gathering of 15 or a convention of 1,500.

SWISSÔFFICE BUSINESS CENTER

Swissôtel Chicago's Business Center offers an impressive array of state-of-the-art equipment and services, including standard photocopying, transparency, GBC binding, secretarial typing, page composition service, telefaxing, teleconferencing and high-speed wireless Internet access.

